

Park Ave. Ties To Center-line points of Sec. Con
 of CATALINA & GOFF.

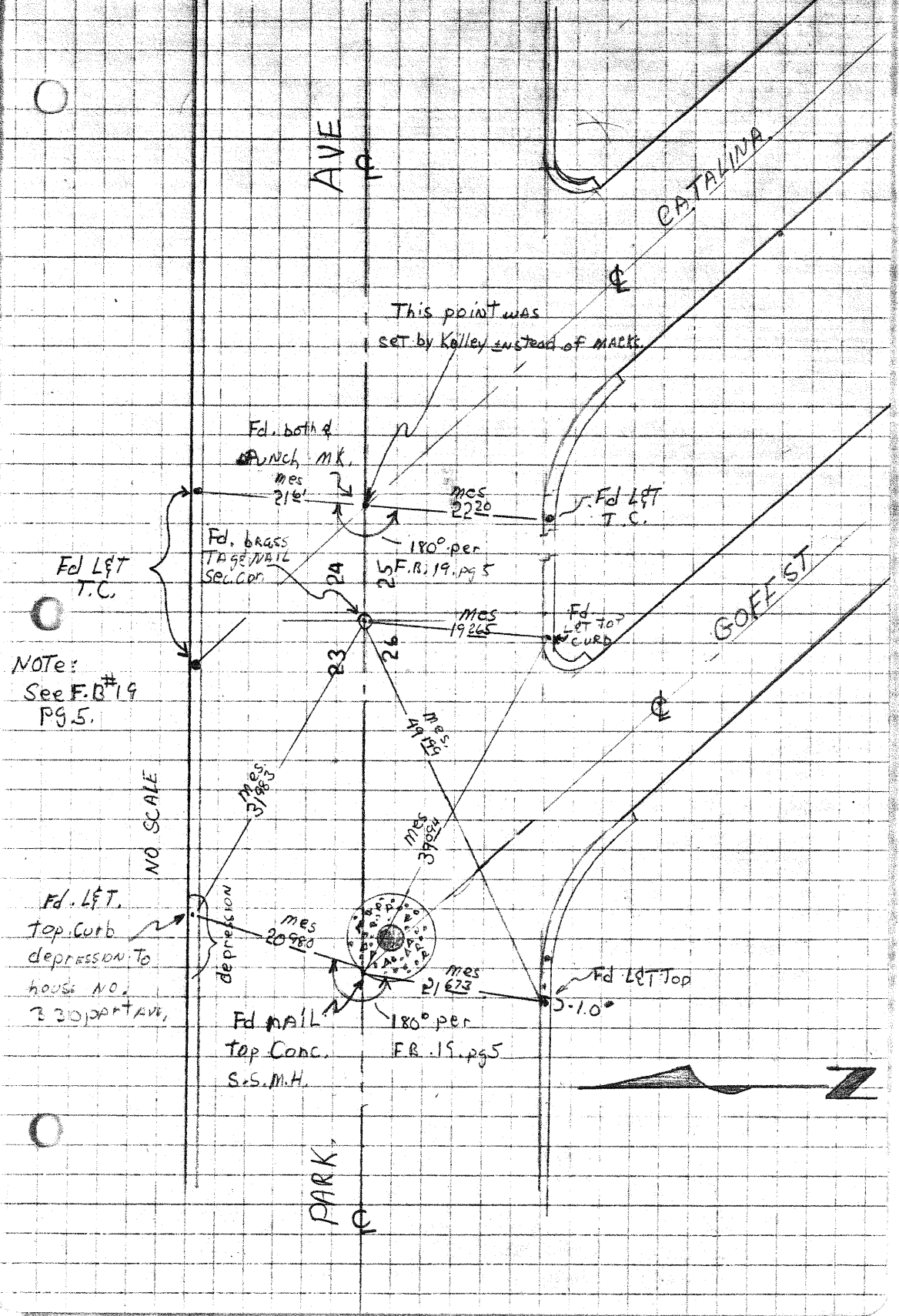

NOTE:
 See F.B.#19
 PG.5.

NO SCALE

F.d. L&T.
 Top Curb
 depression to
 house NO.
 3301 PARK AVE.

F.d. NAIL
 Top CONC.
 S.S.M.H.

180° per
 F.R. 19, pg 5

This point was
 set by Kelley instead of MACK.



PARK
 AVE

PARK
 AVE

CATALINA

GOFF ST