

APPENDIX E

AB 52 Correspondence



June 16, 2022

Mr. Andrew Salas, Chairperson
Gabrieleño Band of Mission Indians – Kizh Nation
P.O. Box 393
Covina, CA 91723

Subject: Notice of Proposed Project Pursuant to Public Resources Code Section 21080.3.1 (Assembly Bill [AB] 52) Consultation for the Anita Street Lift Station Project, Laguna Beach, California

Dear Mr. Salas:

This letter is intended as initial notification to potentially interested Native American tribes and an invitation to undertake formal government-to-government consultation with the City of Laguna Beach on the proposed Anita Street Lift Station Project. Because this project is a CEQA action, it requires an offer of tribal consultation under Assembly Bill [AB] 52 (Public Resources Code Section 21080.3.1).

The proposed project involves the removal of the Anita Street Lift Station and the construction of a wet well to increase reliability, robustness, and to improve the efficiency of operations and safety. Additionally, the project would rehabilitate the Anita Street Coastal Accessway to create a more visually appealing beach access to Anita Beach and install a permanent lifeguard tower to improve public safety.

The project site is currently developed as a beach access stairway and an above ground lift station with landscaping that borders both the stairway and lift station. The site sits just northeast and elevated from the Pacific Ocean. The project site slopes towards the ocean from the northeast portion of the site. The project site is bordered by residential development to the north and south, the ocean to the southwest, and Gaviota Drive to the northeast (refer to Figures 1 and 2). Surrounding land uses are mostly residential with a mix of commercial properties to the northeast. Anita Street Beach is located southeast and adjacent to the project site. The project site is located on the U.S. Geological Survey's (USGS's) 7.5-Minute Laguna Beach, California Quadrangle at Township 7 South; Range 9 West; Section 25 (refer to Figure 3).

The proposed project would replace the existing lift station with a wet well, enhance existing coastal access and install a new permanent lifeguard tower.

An archaeological/historic records search was conducted at the South Central Coastal Information Center at the California State University, Fullerton. The results show that there are no cultural resources recorded on the Project site. Seventeen are located within one-half mile. A Sacred Lands File Search conducted by the Native American Heritage Commission (NAHC) for this project resulted in a positive finding for the presence of Native American sacred sites that yielded human remains in the vicinity of the Project site. The City is prepared to include archaeological and Native American monitoring as a project design feature to ensure proper protocol is followed if resources are unearthed during ground disturbing activities.

Mr. Andrew Salas, Chairperson
Gabrieleño Band of Mission Indians – Kizh Nation
June 16, 2022
Page 2

The City of Laguna Beach maintains a list of interested tribes pursuant to AB 52. You are receiving this letter because you appear on the AB 52 list and wish to be contacted for CEQA projects.

Your participation in this local planning process is important. If you possess any information or knowledge regarding Native American Sacred Lands or other cultural resources in and around the Project site, and wish to consult with the City of Laguna Beach, please contact Hannah Broida, Senior Project Manager at the City. The City would welcome a response at your earliest possible convenience, but no later than 30 days after receiving this letter pursuant to the requirements of AB 52.

Hannah Broida
Senior Project Manager
City of Laguna Beach | Water Quality Department
515 Forest Avenue, Laguna Beach, CA 92651
(949) 464-6615 | hbroida@lagunabeachcity.net

Thank you very much for your assistance. We look forward to your response.

Sincerely,

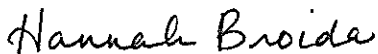

Hannah Broida
Senior Project Manager



Source: City of Laguna Beach, Aerial Photograph, 2008.

ANITA STREET WET WELL AND COASTAL ACCESSWAY IMPROVEMENT PROJECT
Local Vicinity

Figure 1





Source: ESRI, USGS and the City of Laguna Beach; June 2022.



ANITA STREET WET WELL AND COASTAL ACCESSWAY IMPROVEMENT PROJECT
 USGS Topographic Map



June 16, 2022

Chief Anthony Morales
San Gabriel Band of Mission Indians
P.O. Box 693
San Gabriel, CA 91778

Subject: Notice of Proposed Project Pursuant to Public Resources Code Section 21080.3.1 (Assembly Bill [AB] 52) Consultation for the Anita Street Lift Station Project, Laguna Beach, California

Dear Chief Morales:

This letter is intended as initial notification to potentially interested Native American tribes and an invitation to undertake formal government-to-government consultation with the City of Laguna Beach on the proposed Anita Street Lift Station Project. Because this project is a CEQA action, it requires an offer of tribal consultation under Assembly Bill [AB] 52 (Public Resources Code Section 21080.3.1).

The proposed project involves the removal of the Anita Street Lift Station and the construction of a wet well to increase reliability, robustness, and to improve the efficiency of operations and safety. Additionally, the project would rehabilitate the Anita Street Coastal Accessway to create a more visually appealing beach access to Anita Beach and install a permanent lifeguard tower to improve public safety.

The project site is currently developed as a beach access stairway and an above ground lift station with landscaping that borders both the stairway and lift station. The site sits just northeast and elevated from the Pacific Ocean. The project site slopes towards the ocean from the northeast portion of the site. The project site is bordered by residential development to the north and south, the ocean to the southwest, and Gaviota Drive to the northeast (refer to Figures 1 and 2). Surrounding land uses are mostly residential with a mix of commercial properties to the northeast. Anita Street Beach is located southeast and adjacent to the project site. The project site is located on the U.S. Geological Survey's (USGS's) 7.5-Minute Laguna Beach, California Quadrangle at Township 7 South; Range 9 West; Section 25 (refer to Figure 3).

The proposed project would replace the existing lift station with a wet well, enhance existing coastal access and install a new permanent lifeguard tower.

An archaeological/historic records search was conducted at the South Central Coastal Information Center at the California State University, Fullerton. The results show that there are no cultural resources recorded on the Project site. Seventeen are located within one-half mile. A Sacred Lands File Search conducted by the Native American Heritage Commission (NAHC) for this project resulted in a positive finding for the presence of Native American sacred sites that yielded human remains in the vicinity of the Project site. The City is prepared to include archaeological and Native American monitoring as a project design feature to ensure proper protocol is followed if resources are unearthed during ground disturbing activities.

Chief Anthony Morales
San Gabriel Band of Mission Indians
June 16, 2022
Page 2

The City of Laguna Beach maintains a list of interested tribes pursuant to AB 52. You are receiving this letter because you appear on the AB 52 list and wish to be contacted for CEQA projects.

Your participation in this local planning process is important. If you possess any information or knowledge regarding Native American Sacred Lands or other cultural resources in and around the Project site, and wish to consult with the City of Laguna Beach, please contact Hannah Broida, Senior Project Manager at the City. The City would welcome a response at your earliest possible convenience, but no later than 30 days after receiving this letter pursuant to the requirements of AB 52.

Hannah Broida
Senior Project Manager
City of Laguna Beach | Water Quality Department
515 Forest Avenue, Laguna Beach, CA 92651
(949) 464-6615 | hbroida@lagunabeachcity.net

Thank you very much for your assistance. We look forward to your response.

Sincerely,



Hannah Broida
Senior Project Manager



Source: City of Laguna Beach, Aerial Photograph; 2008.

ANITA STREET WET WELL AND COASTAL ACCESSWAY IMPROVEMENT PROJECT
Local Vicinity

Figure 1



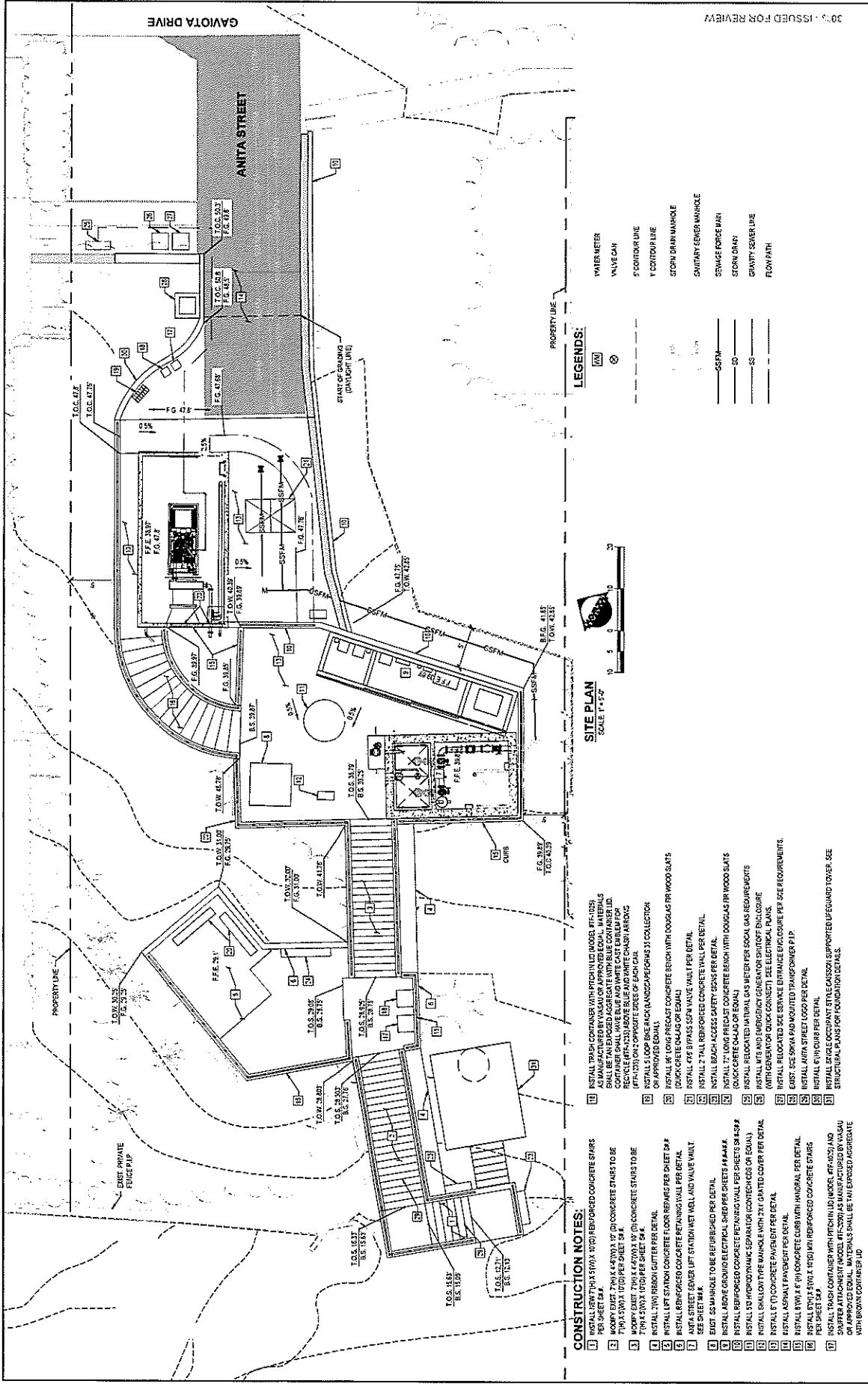

Source: PACE; April 2022.

ANITA STREET WET WELL AND COASTAL ACCESSWAY IMPROVEMENT PROJECT
 Preliminary Site Plan
 Figure 2

VCS Environmental

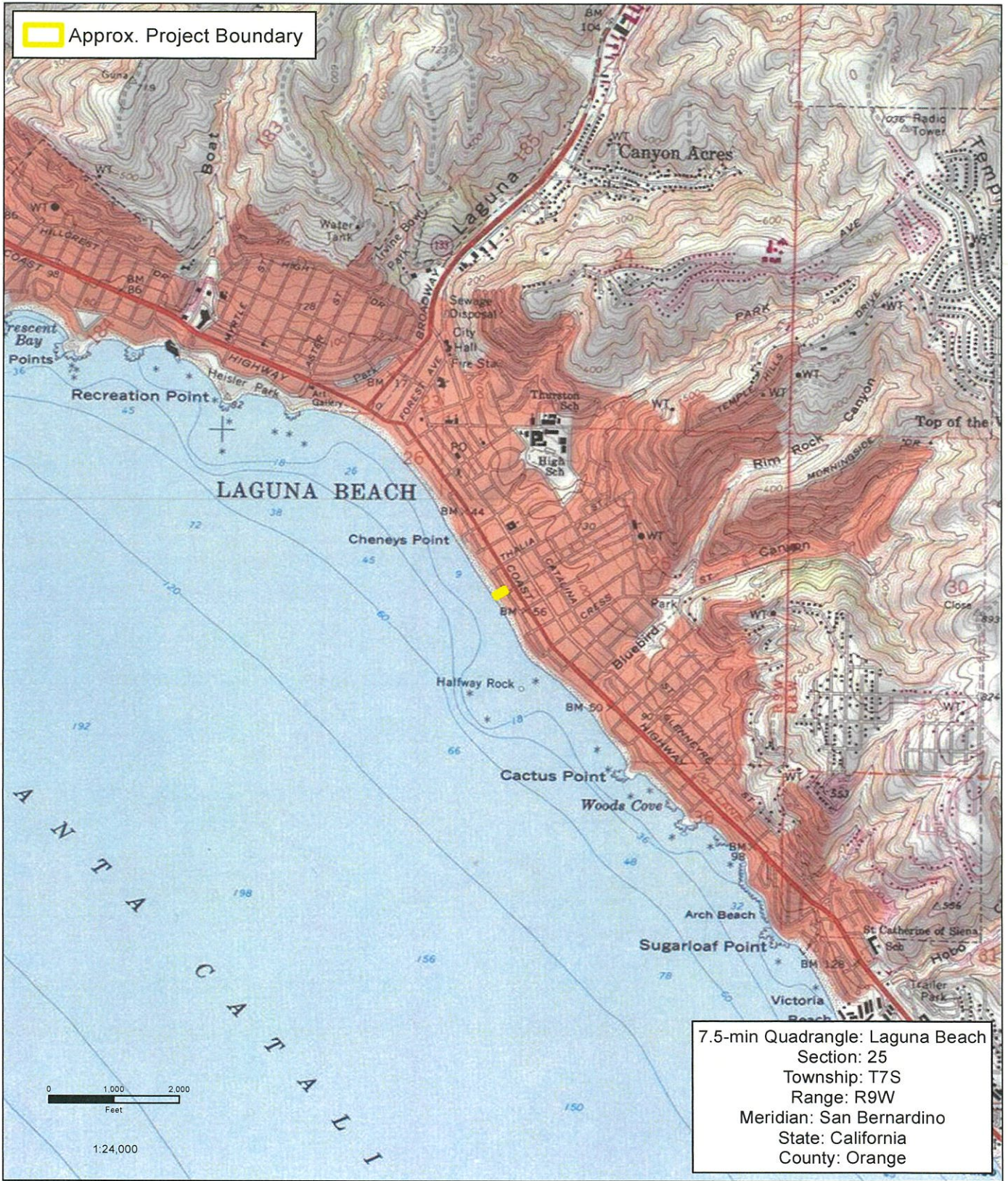

Source: ESRI, USGS and the City of Laguna Beach; June 2022.





June 16, 2022

Mr. Joseph Ontiveros, Cultural Resource Director
Soboba Band of Luiseño Indians
P.O. Box 487
San Jacinto, CA 92581

Subject: Notice of Proposed Project Pursuant to Public Resources Code Section 21080.3.1 (Assembly Bill [AB] 52) Consultation for the Anita Street Lift Station Project, Laguna Beach, California

Dear Mr. Ontiveros:

This letter is intended as initial notification to potentially interested Native American tribes and an invitation to undertake formal government-to-government consultation with the City of Laguna Beach on the proposed Anita Street Lift Station Project. Because this project is a CEQA action, it requires an offer of tribal consultation under Assembly Bill [AB] 52 (Public Resources Code Section 21080.3.1).

The proposed project involves the removal of the Anita Street Lift Station and the construction of a wet well to increase reliability, robustness, and to improve the efficiency of operations and safety. Additionally, the project would rehabilitate the Anita Street Coastal Accessway to create a more visually appealing beach access to Anita Beach and install a permanent lifeguard tower to improve public safety.

The project site is currently developed as a beach access stairway and an above ground lift station with landscaping that borders both the stairway and lift station. The site sits just northeast and elevated from the Pacific Ocean. The project site slopes towards the ocean from the northeast portion of the site. The project site is bordered by residential development to the north and south, the ocean to the southwest, and Gaviota Drive to the northeast (refer to Figures 1 and 2). Surrounding land uses are mostly residential with a mix of commercial properties to the northeast. Anita Street Beach is located southeast and adjacent to the project site. The project site is located on the U.S. Geological Survey's (USGS's) 7.5-Minute Laguna Beach, California Quadrangle at Township 7 South; Range 9 West; Section 25 (refer to Figure 3).

The proposed project would replace the existing lift station with a wet well, enhance existing coastal access and install a new permanent lifeguard tower.

An archaeological/historic records search was conducted at the South Central Coastal Information Center at the California State University, Fullerton. The results show that there are no cultural resources recorded on the Project site. Seventeen are located within one-half mile. A Sacred Lands File Search conducted by the Native American Heritage Commission (NAHC) for this project resulted in a positive finding for the presence of Native American sacred sites that yielded human remains in the vicinity of the Project site. The City is prepared to include archaeological and Native American monitoring as a project design feature to ensure proper protocol is followed if resources are unearthed during ground disturbing activities.

Mr. Joseph Ontiveros, Cultural Resource Director
Soboba Band of Luiseño Indians
June 16, 2022
Page 2

The City of Laguna Beach maintains a list of interested tribes pursuant to AB 52. You are receiving this letter because you appear on the AB 52 list and wish to be contacted for CEQA projects.

Your participation in this local planning process is important. If you possess any information or knowledge regarding Native American Sacred Lands or other cultural resources in and around the Project site, and wish to consult with the City of Laguna Beach, please contact Hannah Broida, Senior Project Manager at the City. The City would welcome a response at your earliest possible convenience, but no later than 30 days after receiving this letter pursuant to the requirements of AB 52.

Hannah Broida
Senior Project Manager
City of Laguna Beach | Water Quality Department
515 Forest Avenue, Laguna Beach, CA 92651
(949) 464-6615 | hbroida@lagunabeachcity.net

Thank you very much for your assistance. We look forward to your response.

Sincerely,



Hannah Broida
Senior Project Manager



Source: City of Laguna Beach, Aerial Photograph, 2008.

ANITA STREET WET WELL AND COASTAL ACCESSWAY IMPROVEMENT PROJECT
Local Vicinity



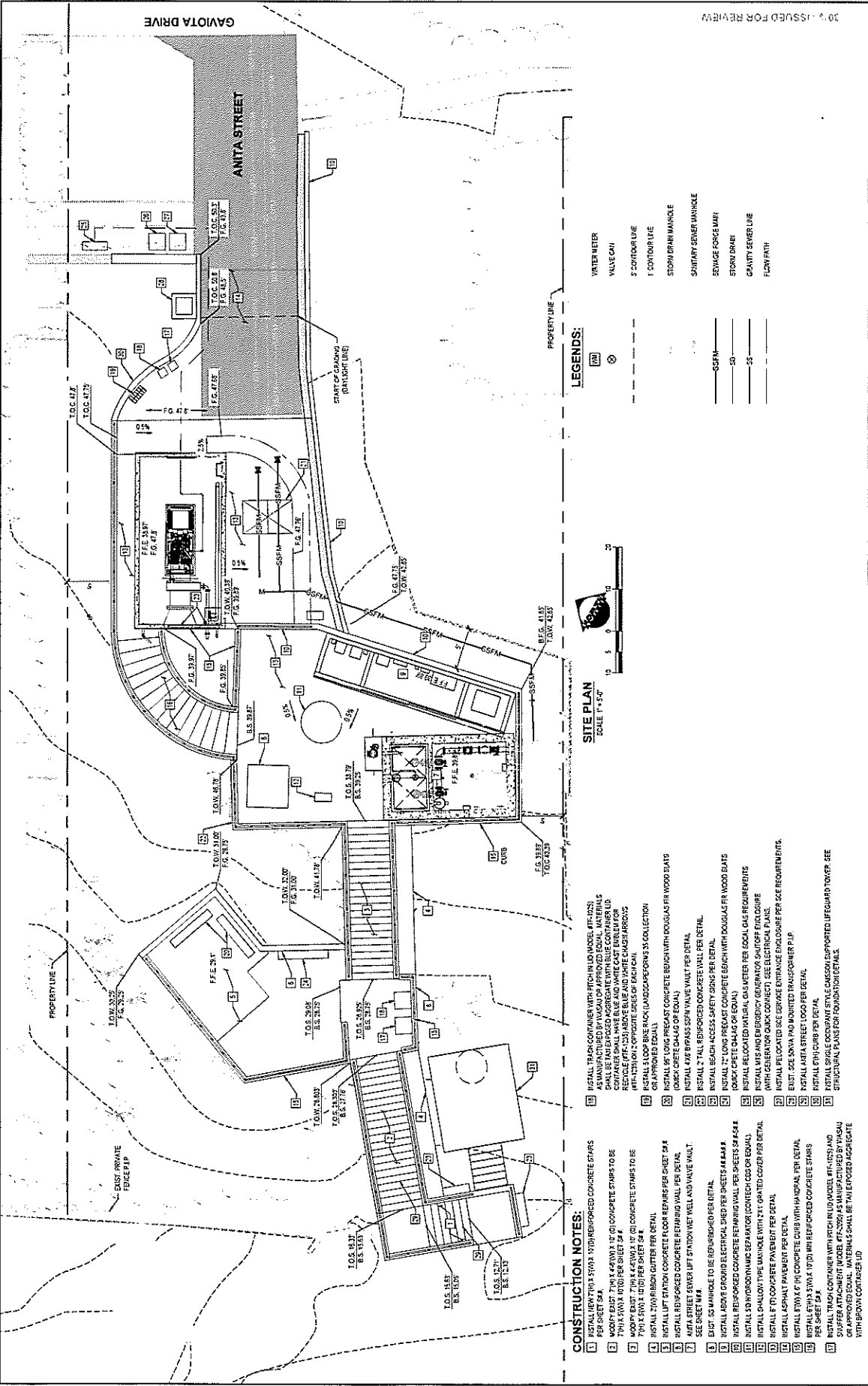

Source: PACE; April 2022.



VCS Environmental

ANITA STREET WET WELL AND COASTAL ACCESSWAY IMPROVEMENT PROJECT Preliminary Site Plan

Figure 2

CONSTRUCTION NOTES:

- 1 INSTALL 2" DIA. 1" THICK REINFORCED CONCRETE STAIRS PER SHEET SA
- 2 WOODP EAST 7/16 X 4 1/2 @ 1.0' O/C CONCRETE STAIRS TO BE 7/16 X 5/8 @ 1.0' O/C PER SHEET SA
- 3 WOODP EAST 7/16 X 4 1/2 @ 1.0' O/C CONCRETE STAIRS TO BE 7/16 X 5/8 @ 1.0' O/C PER SHEET SA
- 4 INSTALL 2" THICK REINFORCED CONCRETE PER DETAIL
- 5 INSTALL 2" THICK REINFORCED CONCRETE FLOOR REPAIRS PER SHEET SA
- 6 ANITA STREET SEWER LIFT STATION WET WELL AND VALVE VAULT SEE SHEET M3
- 7 EXIST 10" MANHOLE TO BE REBURIED PER DETAIL
- 8 INSTALL 18" DIA. 6" THICK CONCRETE CURB WITH 16" W/ID. PER DETAIL
- 9 W/ID. PER DETAIL
- 10 W/ID. PER DETAIL
- 11 W/ID. PER DETAIL
- 12 W/ID. PER DETAIL
- 13 W/ID. PER DETAIL
- 14 W/ID. PER DETAIL
- 15 W/ID. PER DETAIL
- 16 W/ID. PER DETAIL
- 17 W/ID. PER DETAIL
- 18 W/ID. PER DETAIL
- 19 W/ID. PER DETAIL
- 20 W/ID. PER DETAIL
- 21 W/ID. PER DETAIL
- 22 W/ID. PER DETAIL
- 23 W/ID. PER DETAIL
- 24 W/ID. PER DETAIL
- 25 W/ID. PER DETAIL
- 26 W/ID. PER DETAIL
- 27 W/ID. PER DETAIL
- 28 W/ID. PER DETAIL
- 29 W/ID. PER DETAIL
- 30 W/ID. PER DETAIL
- 31 W/ID. PER DETAIL
- 32 W/ID. PER DETAIL
- 33 W/ID. PER DETAIL
- 34 W/ID. PER DETAIL
- 35 W/ID. PER DETAIL
- 36 W/ID. PER DETAIL
- 37 W/ID. PER DETAIL
- 38 W/ID. PER DETAIL
- 39 W/ID. PER DETAIL
- 40 W/ID. PER DETAIL
- 41 W/ID. PER DETAIL
- 42 W/ID. PER DETAIL
- 43 W/ID. PER DETAIL
- 44 W/ID. PER DETAIL
- 45 W/ID. PER DETAIL
- 46 W/ID. PER DETAIL
- 47 W/ID. PER DETAIL
- 48 W/ID. PER DETAIL
- 49 W/ID. PER DETAIL
- 50 W/ID. PER DETAIL

LEGENDS:

- WATER METER
- VALVE CHAIN
- 1" CONTOUR LINE
- 1" CONTOUR LINE
- STORM DRAIN MANHOLE
- SEWAGE FORCE MAIN
- STORM DRAIN
- SEWAGE FORCE MAIN
- GRAVITY SEWER LINE
- FLOW PATH

NOT FOR CONSTRUCTION



SITE PLAN
SCALE 1" = 50'

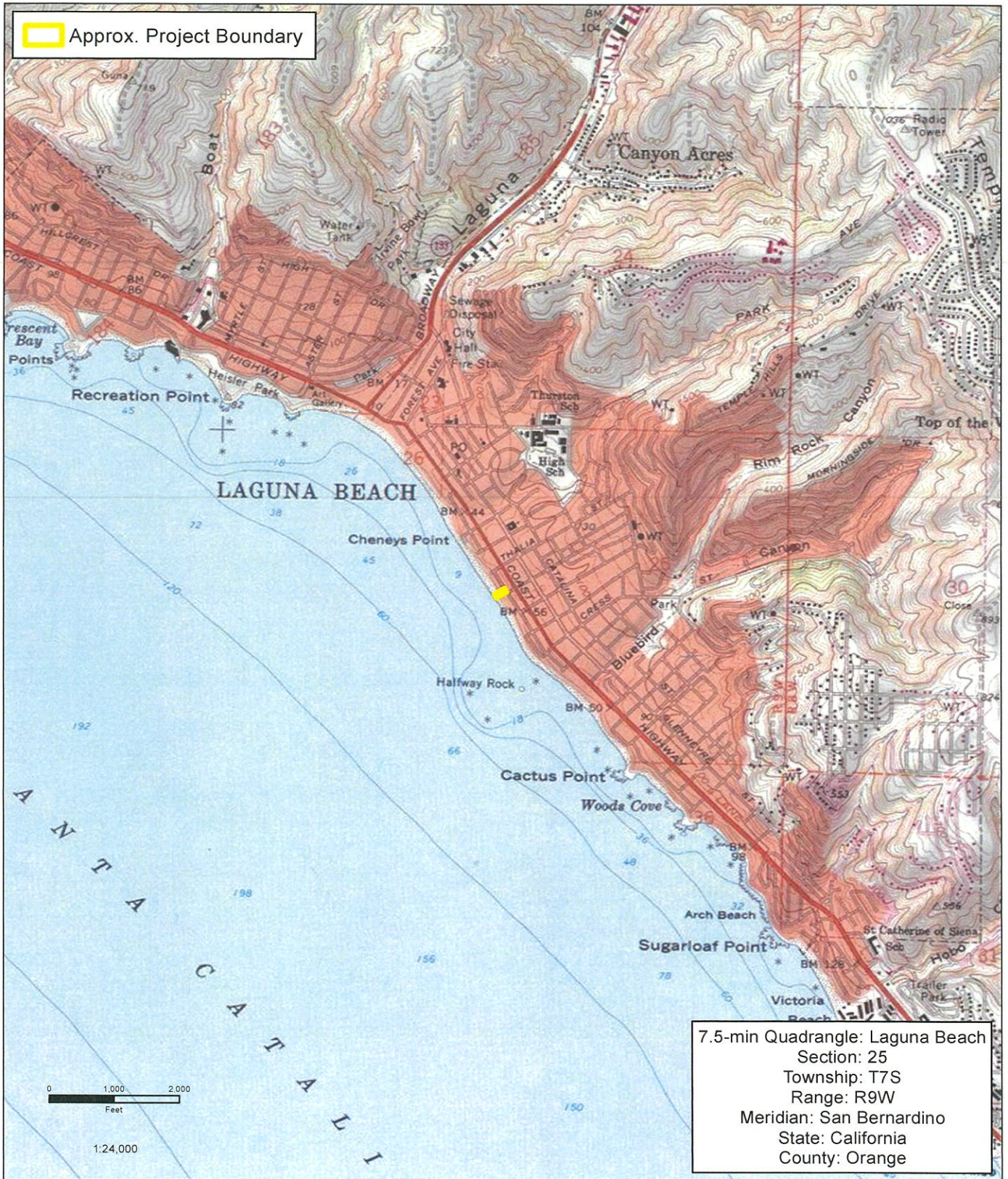

Source: ESRI, USGS and the City of Laguna Beach; June 2022.



ANITA STREET WET WELL AND COASTAL ACCESSWAY IMPROVEMENT PROJECT
 USGS Topographic Map



June 16, 2022

Ms. Joyce Stanfield Perry, Tribal Manager
Juaneno Band of Mission Indians
4955 Paseo Segovia
Irvine, CA 92603

Subject: Notice of Proposed Project Pursuant to Public Resources Code Section 21080.3.1 (Assembly Bill [AB] 52) Consultation for the Anita Street Lift Station Project, Laguna Beach, California

Dear Ms. Perry:

This letter is intended as initial notification to potentially interested Native American tribes and an invitation to undertake formal government-to-government consultation with the City of Laguna Beach on the proposed Anita Street Lift Station Project. Because this project is a CEQA action, it requires an offer of tribal consultation under Assembly Bill [AB] 52 (Public Resources Code Section 21080.3.1).

The proposed project involves the removal of the Anita Street Lift Station and the construction of a wet well to increase reliability, robustness, and to improve the efficiency of operations and safety. Additionally, the project would rehabilitate the Anita Street Coastal Accessway to create a more visually appealing beach access to Anita Beach and install a permanent lifeguard tower to improve public safety.

The project site is currently developed as a beach access stairway and an above ground lift station with landscaping that borders both the stairway and lift station. The site sits just northeast and elevated from the Pacific Ocean. The project site slopes towards the ocean from the northeast portion of the site. The project site is bordered by residential development to the north and south, the ocean to the southwest, and Gaviota Drive to the northeast (refer to Figures 1 and 2). Surrounding land uses are mostly residential with a mix of commercial properties to the northeast. Anita Street Beach is located southeast and adjacent to the project site. The project site is located on the U.S. Geological Survey's (USGS's) 7.5-Minute Laguna Beach, California Quadrangle at Township 7 South; Range 9 West; Section 25 (refer to Figure 3).

The proposed project would replace the existing lift station with a wet well, enhance existing coastal access and install a new permanent lifeguard tower.

An archaeological/historic records search was conducted at the South Central Coastal Information Center at the California State University, Fullerton. The results show that there are no cultural resources recorded on the Project site. Seventeen are located within one-half mile. A Sacred Lands File Search conducted by the Native American Heritage Commission (NAHC) for this project resulted in a positive finding for the presence of Native American sacred sites that yielded human remains in the vicinity of the Project site. The City is prepared to include archaeological and Native American monitoring as a project design feature to ensure proper protocol is followed if resources are unearthed during ground disturbing activities.

Ms. Joyce Stanfield Perry, Tribal Manager
Juaneno Band of Mission Indians
June 16, 2022
Page 2

The City of Laguna Beach maintains a list of interested tribes pursuant to AB 52. You are receiving this letter because you appear on the AB 52 list and wish to be contacted for CEQA projects.

Your participation in this local planning process is important. If you possess any information or knowledge regarding Native American Sacred Lands or other cultural resources in and around the Project site, and wish to consult with the City of Laguna Beach, please contact Hannah Broida, Senior Project Manager at the City. The City would welcome a response at your earliest possible convenience, but no later than 30 days after receiving this letter pursuant to the requirements of AB 52.

Hannah Broida
Senior Project Manager
City of Laguna Beach | Water Quality Department
515 Forest Avenue, Laguna Beach, CA 92651
(949) 464-6615 | hbroida@lagunabeachcity.net

Thank you very much for your assistance. We look forward to your response.

Sincerely,



Hannah Broida
Senior Project Manager



Source: City of Laguna Beach, Aerial Photograph; 2008.

ANITA STREET WET WELL AND COASTAL ACCESSWAY IMPROVEMENT PROJECT
Local Vicinity

Figure 1



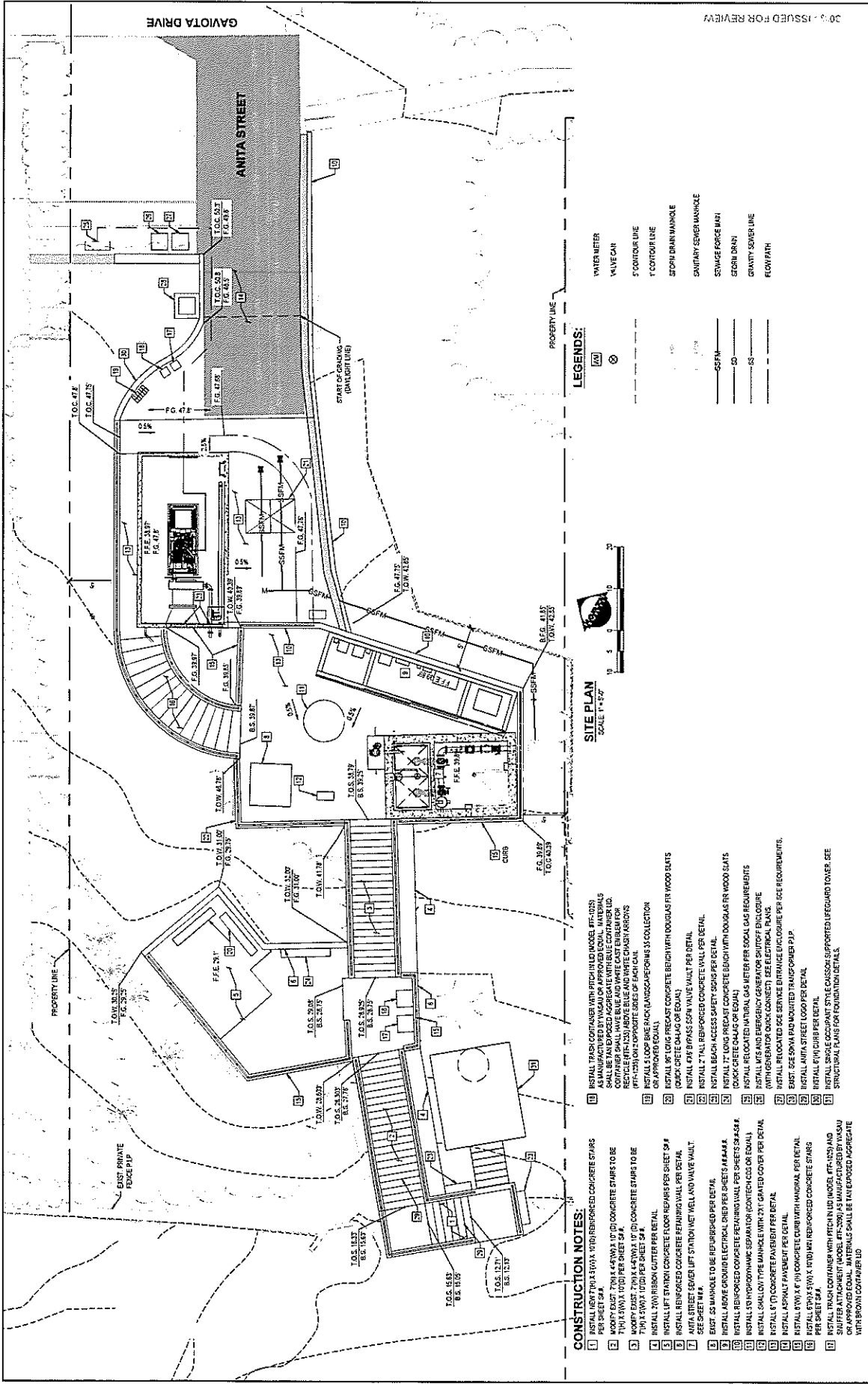

- LEGENDS:**
- WATER METER
 - VALVE CAN
 - 5" CONTOUR LINE
 - 1" CONTOUR LINE
 - SEWAL DRAIN MAINLINE
 - SANITARY SEWER MAINLINE
 - SEWAGE FORCE MAIN
 - SEWAL DRAIN
 - GRAVITY SEWER LINE
 - FLOW PATH

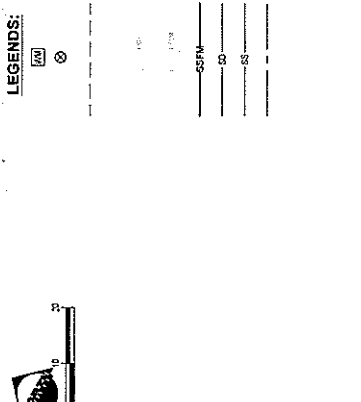

- CONSTRUCTION NOTES:**
- 1) INSTALL LEFT TURN LIFT STATION WITH REINFORCED CONCRETE STAIRS PER SHEET SA-1.
 - 2) MOORFY EAST 70X144X10 (10) CONCRETE STAIRS TO BE 70X144X10 (10) PER SHEET SA-1.
 - 3) MOORFY EAST 70X144X10 (10) CONCRETE STAIRS TO BE 70X144X10 (10) PER SHEET SA-1.
 - 4) INSTALL 100 RIBBON GUTTER PER DETAIL.
 - 5) INSTALL LEFT STATION CONCRETE FLOOR REPAIRS PER SHEET SA-1.
 - 6) ANITA STREET SEWER LIFT STATION WET WELL AND VALVE VAULT SEE SHEET SA-1.
 - 7) EAST 50 MANHOLE TO BE REBURIED PER DETAIL.
 - 8) INSTALL ABOVE GROUND ELECTRICAL ONE PER SHEETS SA-1 & SA-2.
 - 9) INSTALL REINFORCED CONCRETE PERMANENT WALL PER SHEETS SA-1 & SA-2.
 - 10) INSTALL 10 REINFORCED CONCRETE PERMANENT WALL PER SHEETS SA-1 & SA-2.
 - 11) INSTALL CONCRETE TYPE MANHOLE WITH 21" GATED COVER PER DETAIL.
 - 12) INSTALL 10" CONCRETE FAN INLET PER DETAIL.
 - 13) INSTALL 10" (10) CONCRETE CURB WITH MANHOLE PER DETAIL.
 - 14) INSTALL 10" (10) CONCRETE CURB WITH MANHOLE PER DETAIL.
 - 15) INSTALL TRUSS CONTAINER WITH REIN IN LID MODEL: PFC-1023 AND STIFFER ATTACHMENT MODEL: PFC-2090 AS MANUFACTURED BY WASSAU OR APPROVED EQUAL. MATERIALS SHALL BE TYPED REBAR AGGREGATE WITH BROWN CONTAINER LID.
 - 16) INSTALL TRUSS CONTAINER WITH REIN IN LID MODEL: PFC-1023 AS MANUFACTURED BY WASSAU OR APPROVED EQUAL. MATERIALS SHALL BE TYPED REBAR AGGREGATE WITH BROWN CONTAINER LID.
 - 17) INSTALL 17" LONG PRECAST CONCRETE BEIGN WITH DOUGLAS FIR WOOD SITS (CHECK CRETE DRAINAGE OR EQUAL).
 - 18) INSTALL 7" WALL REINFORCED CONCRETE WALL PER DETAIL.
 - 19) INSTALL 17" LONG PRECAST CONCRETE BEIGN WITH DOUGLAS FIR WOOD SITS (CHECK CRETE DRAINAGE OR EQUAL).
 - 20) INSTALL 17" LONG PRECAST CONCRETE BEIGN WITH DOUGLAS FIR WOOD SITS (CHECK CRETE DRAINAGE OR EQUAL).
 - 21) INSTALL RELOCATED NATURAL GAS METER PER SOCIAL GAS REQUIREMENTS (WITH GENERATOR QUANT CONNECT). SEE ELECTRICAL PLANS.
 - 22) RELOCATED GAS SERVICE ENTRANCE ENCLOSURE PER GAS REQUIREMENTS.
 - 23) EAST 50 MANHOLE PAD MOUNTED TRANSFORMER P.P.P.
 - 24) INSTALL ANITA STREET LOOP PER DETAIL.
 - 25) INSTALL 6" (6) CURB PER DETAIL.
 - 26) INSTALL SHADE OCCUPANT STYLE CAISSON SUPPORTED (LEGUARD) TOWER. SEE STRUCTURAL PLANS FOR FOUNDATION DETAILS.



Source: ESRI, USGS and the City of Laguna Beach; June 2022.





June 16, 2022

Ms. Linda Candelaria
Gabrielino-Tongva Tribe
80839 Camino Santa Juliana
Indio, CA 92203

Subject: Notice of Proposed Project Pursuant to Public Resources Code Section 21080.3.1 (Assembly Bill [AB] 52) Consultation for the Anita Street Lift Station Project, Laguna Beach, California

Dear Ms. Candelaria:

This letter is intended as initial notification to potentially interested Native American tribes and an invitation to undertake formal government-to-government consultation with the City of Laguna Beach on the proposed Anita Street Lift Station Project. Because this project is a CEQA action, it requires an offer of tribal consultation under Assembly Bill [AB] 52 (Public Resources Code Section 21080.3.1).

The proposed project involves the removal of the Anita Street Lift Station and the construction of a wet well to increase reliability, robustness, and to improve the efficiency of operations and safety. Additionally, the project would rehabilitate the Anita Street Coastal Accessway to create a more visually appealing beach access to Anita Beach and install a permanent lifeguard tower to improve public safety.

The project site is currently developed as a beach access stairway and an above ground lift station with landscaping that borders both the stairway and lift station. The site sits just northeast and elevated from the Pacific Ocean. The project site slopes towards the ocean from the northeast portion of the site. The project site is bordered by residential development to the north and south, the ocean to the southwest, and Gaviota Drive to the northeast (refer to Figures 1 and 2). Surrounding land uses are mostly residential with a mix of commercial properties to the northeast. Anita Street Beach is located southeast and adjacent to the project site. The project site is located on the U.S. Geological Survey's (USGS's) 7.5-Minute Laguna Beach, California Quadrangle at Township 7 South; Range 9 West; Section 25 (refer to Figure 3).

The proposed project would replace the existing lift station with a wet well, enhance existing coastal access and install a new permanent lifeguard tower.

An archaeological/historic records search was conducted at the South Central Coastal Information Center at the California State University, Fullerton. The results show that there are no cultural resources recorded on the Project site. Seventeen are located within one-half mile. A Sacred Lands File Search conducted by the Native American Heritage Commission (NAHC) for this project resulted in a positive finding for the presence of Native American sacred sites that yielded human remains in the vicinity of the Project site. The City is prepared to include archaeological and Native American monitoring as a project design feature to ensure proper protocol is followed if resources are unearthed during ground disturbing activities.

Ms. Linda Candelaria
Gabrielino-Tongva Tribe
June 16, 2022
Page 2

The City of Laguna Beach maintains a list of interested tribes pursuant to AB 52. You are receiving this letter because you appear on the AB 52 list and wish to be contacted for CEQA projects.

Your participation in this local planning process is important. If you possess any information or knowledge regarding Native American Sacred Lands or other cultural resources in and around the Project site, and wish to consult with the City of Laguna Beach, please contact Hannah Broida, Senior Project Manager at the City. The City would welcome a response at your earliest possible convenience, but no later than 30 days after receiving this letter pursuant to the requirements of AB 52.

Hannah Broida
Senior Project Manager
City of Laguna Beach | Water Quality Department
515 Forest Avenue, Laguna Beach, CA 92651
(949) 464-6615 | hbroida@lagunabeachcity.net

Thank you very much for your assistance. We look forward to your response.

Sincerely,



Hannah Broida
Senior Project Manager



Source: City of Laguna Beach, Aerial Photograph, 2008.



ANITA STREET WET WELL AND COASTAL ACCESSWAY IMPROVEMENT PROJECT
Local Vicinity

Figure 1

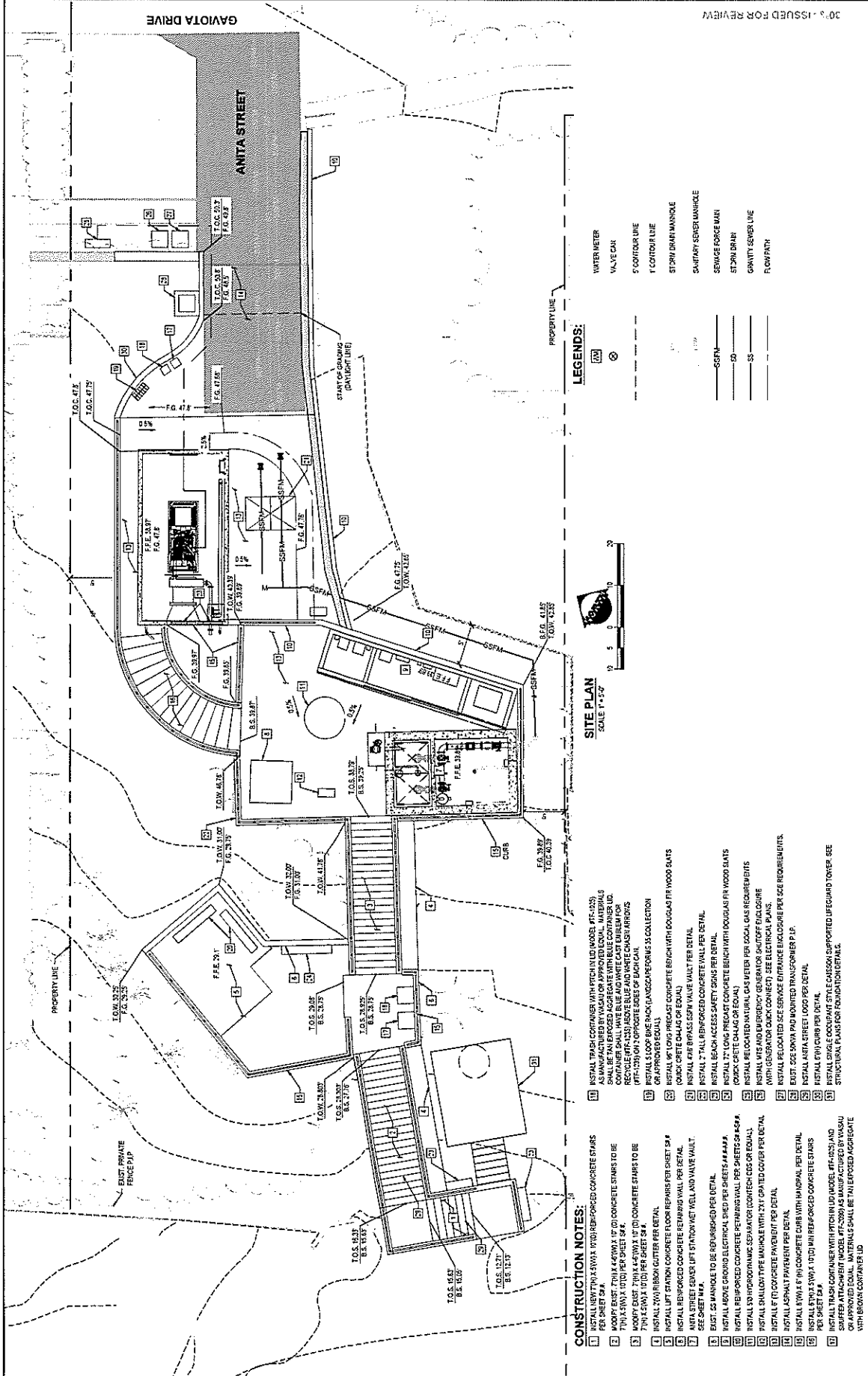

ANITA STREET WET WELL AND COASTAL ACCESSWAY IMPROVEMENT PROJECT
 Preliminary Site Plan
 Figure 2

CONSTRUCTION NOTES:

1. 12\"/>
- 2. MOOPY EXIST. 7\"/>
- 3. MOOPY EXIST. 7\"/>
- 4. 12\"/>
- 5. 12\"/>
- 6. ANITA STREET SEWER LIFT STATION W/ WELL AND VALVE VAULT. SEE SHEET M.V. 4.
- 7. EXIST. 20\"/>
- 8. 12\"/>
- 9. 12\"/>
- 10. 12\"/>
- 11. 12\"/>
- 12. 12\"/>
- 13. 12\"/>
- 14. 12\"/>
- 15. 12\"/>
- 16. 12\"/>
- 17. 12\"/>
- 18. 12\"/>
- 19. 12\"/>
- 20. 12\"/>
- 21. 12\"/>
- 22. 12\"/>
- 23. 12\"/>
- 24. 12\"/>
- 25. 12\"/>
- 26. 12\"/>
- 27. 12\"/>
- 28. 12\"/>
- 29. 12\"/>
- 30. 12\"/>
- 31. 12\"/>

LEGENDS:

- WATER METER
- VALVE CIST
- 5\"/>
- 1\"/>
- STORM DRAIN MANHOLE
- SAINTARY SEWER MANHOLE
- SEWER FORCE MAIN
- STORM DRAIN
- GRAVITY SEWER LINE
- FLOW PATH

SITE PLAN
 SCALE: 1" = 50'

30% ISSUED FOR REVIEW



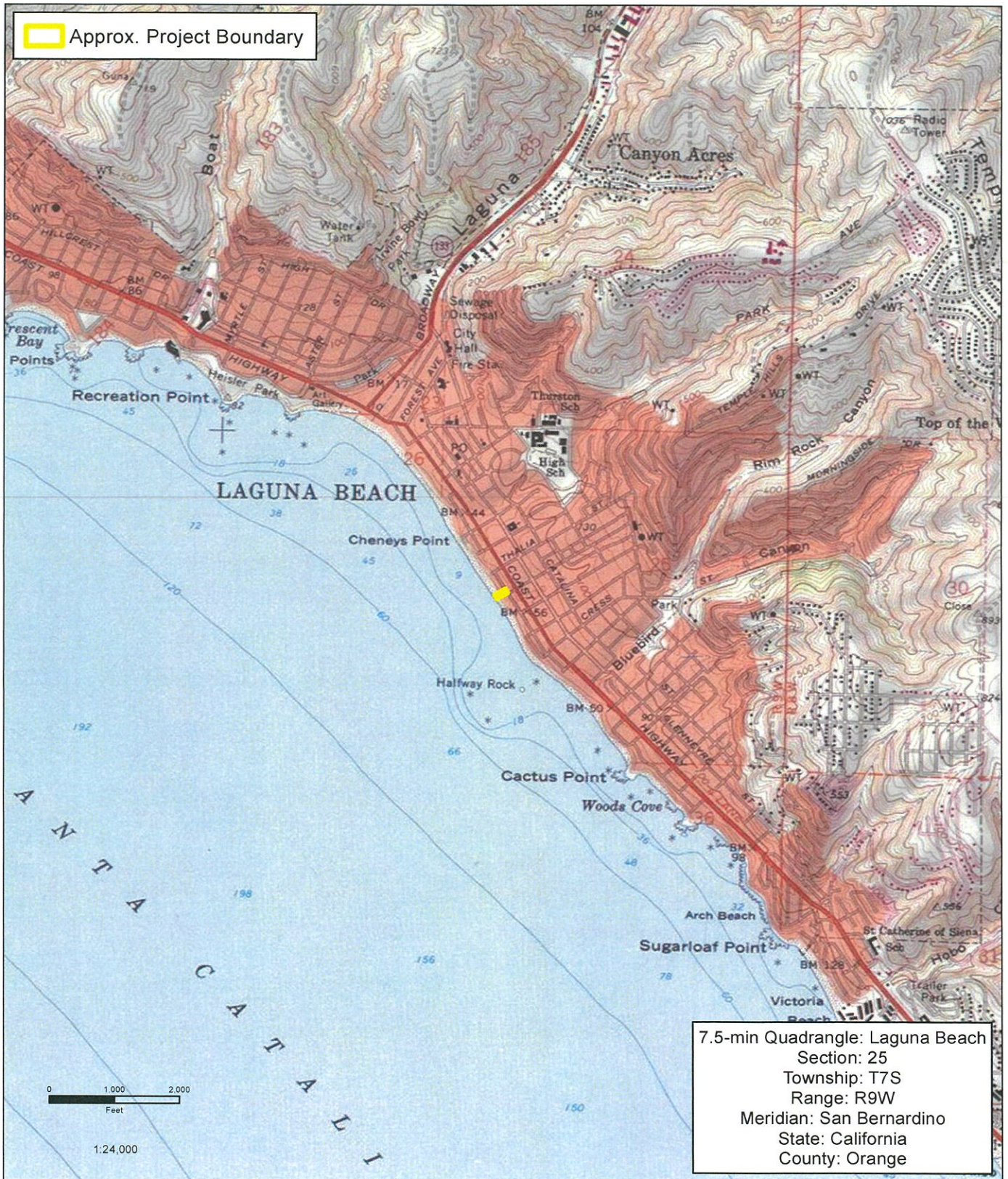

Source: ESRI, USGS and the City of Laguna Beach; June 2022.



ANITA STREET WET WELL AND COASTAL ACCESSWAY IMPROVEMENT PROJECT
 USGS Topographic Map



June 16, 2022

Ms. Patricia Martz, Ph.D.
California Cultural Resource Preservation Alliance, Inc.
P.O. Box 54132
Irvine, CA 92619-4132

Subject: Notice of Proposed Project Pursuant to Public Resources Code Section 21080.3.1 (Assembly Bill [AB] 52) Consultation for the Anita Street Lift Station Project, Laguna Beach, California

Dear Ms. Martz:

This letter is intended as initial notification to potentially interested Native American tribes and an invitation to undertake formal government-to-government consultation with the City of Laguna Beach on the proposed Anita Street Lift Station Project. Because this project is a CEQA action, it requires an offer of tribal consultation under Assembly Bill [AB] 52 (Public Resources Code Section 21080.3.1).

The proposed project involves the removal of the Anita Street Lift Station and the construction of a wet well to increase reliability, robustness, and to improve the efficiency of operations and safety. Additionally, the project would rehabilitate the Anita Street Coastal Accessway to create a more visually appealing beach access to Anita Beach and install a permanent lifeguard tower to improve public safety.

The project site is currently developed as a beach access stairway and an above ground lift station with landscaping that borders both the stairway and lift station. The site sits just northeast and elevated from the Pacific Ocean. The project site slopes towards the ocean from the northeast portion of the site. The project site is bordered by residential development to the north and south, the ocean to the southwest, and Gaviota Drive to the northeast (refer to Figures 1 and 2). Surrounding land uses are mostly residential with a mix of commercial properties to the northeast. Anita Street Beach is located southeast and adjacent to the project site. The project site is located on the U.S. Geological Survey's (USGS's) 7.5-Minute Laguna Beach, California Quadrangle at Township 7 South; Range 9 West; Section 25 (refer to Figure 3).

The proposed project would replace the existing lift station with a wet well, enhance existing coastal access and install a new permanent lifeguard tower.

An archaeological/historic records search was conducted at the South Central Coastal Information Center at the California State University, Fullerton. The results show that there are no cultural resources recorded on the Project site. Seventeen are located within one-half mile. A Sacred Lands File Search conducted by the Native American Heritage Commission (NAHC) for this project resulted in a positive finding for the presence of Native American sacred sites that yielded human remains in the vicinity of the Project site. The City is prepared to include archaeological and Native American monitoring as a project design feature to ensure proper protocol is followed if resources are unearthed during ground disturbing activities.

Ms. Patricia Martz, Ph.D.
California Cultural Resource Preservation Alliance, Inc.
June 16, 2022
Page 2

The City of Laguna Beach maintains a list of interested tribes pursuant to AB 52. You are receiving this letter because you appear on the AB 52 list and wish to be contacted for CEQA projects.

Your participation in this local planning process is important. If you possess any information or knowledge regarding Native American Sacred Lands or other cultural resources in and around the Project site, and wish to consult with the City of Laguna Beach, please contact Hannah Broida, Senior Project Manager at the City. The City would welcome a response at your earliest possible convenience, but no later than 30 days after receiving this letter pursuant to the requirements of AB 52.

Hannah Broida
Senior Project Manager
City of Laguna Beach | Water Quality Department
515 Forest Avenue, Laguna Beach, CA 92651
(949) 464-6615 | hbroida@lagunabeachcity.net

Thank you very much for your assistance. We look forward to your response.

Sincerely,



Hannah Broida
Senior Project Manager



Source: City of Laguna Beach, Aerial Photography; 2008.

ANITA STREET WET WELL AND COASTAL ACCESSWAY IMPROVEMENT PROJECT
Local Vicinity



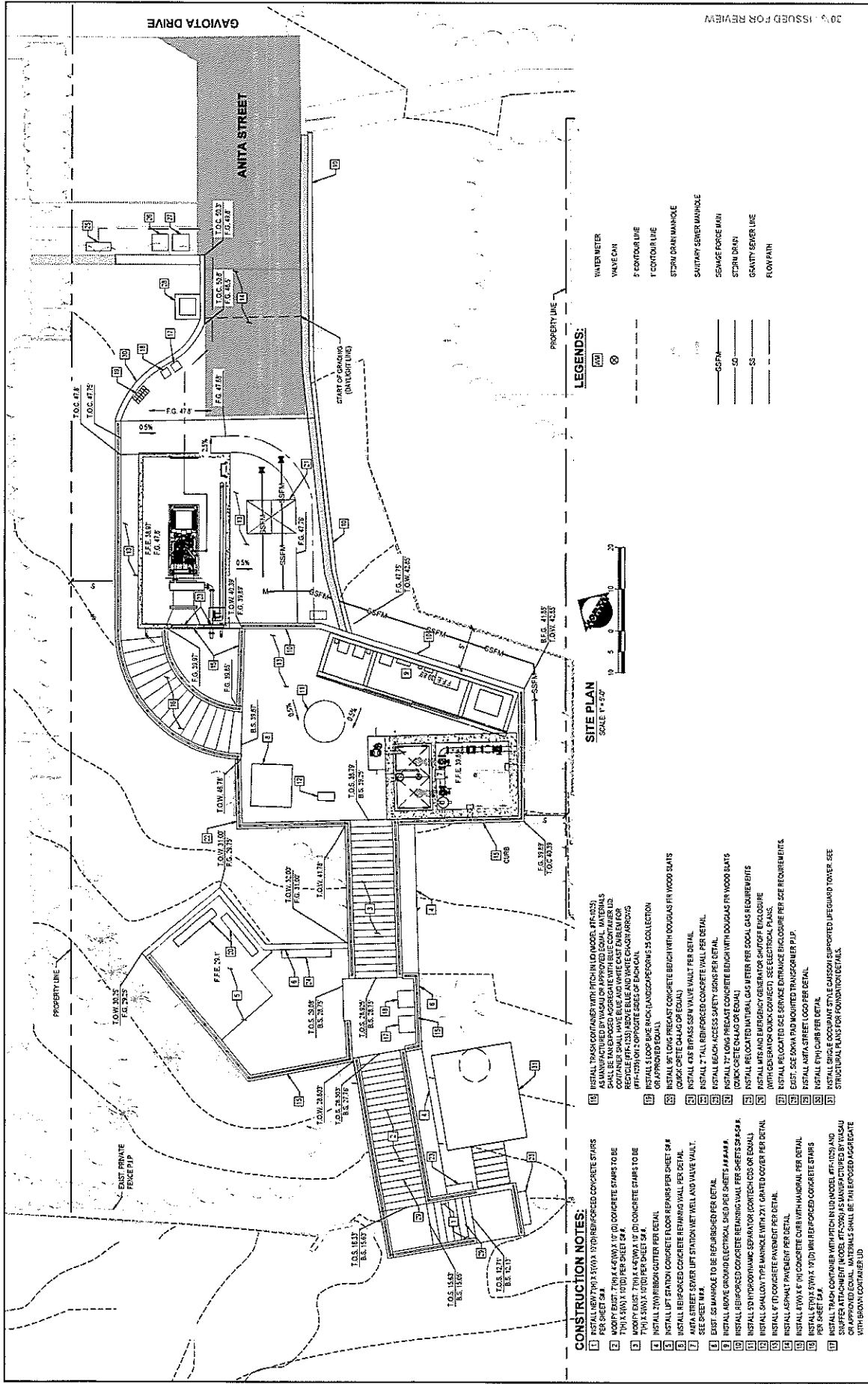

Source: PACE; April 2022.

ANITA STREET WET WELL AND COASTAL ACCESSWAY IMPROVEMENT PROJECT
 Preliminary Site Plan
 Figure 2

VCS Environmental



Source: ESRI, USGS and the City of Laguna Beach; June 2022.



ANITA STREET WET WELL AND COASTAL ACCESSWAY IMPROVEMENT PROJECT
USGS Topographic Map